



**NEW MEXICO STATE UNIVERSITY BOARD OF REGENTS
REGULAR MEETING
April 1, 2026, at 1:30 PM**

Educational Services Building, Regents Room
1780 East University Avenue, Las Cruces, NM
LIVESTREAMED AT <https://regents.nmsu.edu/regent-meetings/>

Regents of New Mexico State University

Chair Ammu Devasthali, Vice Chair Deborah Romero, Secretary/Treasurer Christopher T. Saucedo, Marisol Olivas, Ricardo Gonzales

Non-Voting Advisory Members - ASNMSU President Wyatt Ziehe, Faculty Senate Chair Vimal Chaitanya, Ph.D., Employee Council Chair Sonia A. White

University Officials - President Valerio Ferme, Ph.D., Interim Provost Lakshmi Reddi, Ph.D., Vice President for Administration and Finance Allen Bottorff, P.E., Ph.D., General Counsel Lisa Henderson, J.D.

AGENDA

A. **Call to Order**, *Chairwoman Ammu Devasthali*

Pledge of Allegiance

1. **Introduction of the Media and Elected Officials**, *Chief of Staff Justin Bannister*
2. **Introductions**
3. **Confirmation of Quorum**, *Chairwoman Ammu Devasthali*
4. **Approval of the Agenda**, *Chairwoman Ammu Devasthali*

B. **Approval of Minutes**

1. **Regular Meeting on March 9, 2026**

C. **Regent Committee Reports**

1. **Financial Strategies, Performance and Budget Committee Report**, *Regent Deborah Romero*

D. **Advisory Member Reports**

1. **Associated Students of NMSU Report**, *President Wyatt Ziehe*
2. **NMSU Faculty Senate Report**, *Chair Vimal Chaitanya*
3. **NMSU Employee Council Report**, *Chair Sonia A. White*

E. **Public Comment**, *Associate Vice President Abby Butler*

F. **Consent Items**, *Chairwoman Ammu Devasthali*

1. **Atkinson Music Building Roof C Replacement**, *Interim Associate Vice President Scott Eschenbrenner*
2. **Genesis A Renovations and Pilot Lab Expansion**, *Interim Associate Vice President Scott Eschenbrenner*

G. **Action Items**, *Chairwoman Ammu Devasthali*

1. **NMSU Alamogordo Books4Less \$4 Per Credit Hour Increase**,
NMSU Alamogordo Campus Executive/Academic Officer Mark Cal
2. **Dining Rates Increase of 3.7% to Premium and Voluntary Student Meal Plans**
Auxiliary Services Assistant Vice President Jacob Nevarez
3. **Tuition & Mandatory Fees for All Campuses**,
Chief Budget Officer Kim Rumford

H. **Informational Items**, *Chairwoman Ammu Devasthali*

1. **None.**

I. **NMSU System Report**, *President Valerio Ferme*

J. **Announcements and Comments**, *Chairwoman Ammu Devasthali*

1. **Good News for NMSU!**

K. **Adjournment**, *Chairwoman Ammu Devasthali*



Board of Regents Meeting
Meeting Date: April 1, 2026
Agenda Item Cover Page

Agenda Item # B-1

- Action Item
- Consent Item
- Informational Item

Presented By: Christopher Saucedo
Secretary/Treasurer,
NMSU Board of Regents

Agenda Item: Regular Meeting Minutes on March 9, 2026

Requested Action of the Board of Regents: Approval of the Regular Meeting Minutes for March 9, 2026, as presented.

Executive Summary:

As required by the New Mexico Open Meetings Act, the board shall keep written minutes of all its meetings. The minutes shall include at a minimum the date, time and place of the meeting, the names of members in attendance and those absent, the substance of the proposals considered and a record of any decisions and votes taken that show how each member voted. All minutes are open to public inspection. Draft minutes shall be prepared within ten working days after the meeting and shall be approved, amended or disapproved at the next meeting where a quorum is present. Minutes shall not become official until approved by the board.

References:

NM Open Meetings Act §10-15-1 G.

Prior Approvals:

N/A



**NEW MEXICO STATE UNIVERSITY BOARD OF REGENTS
REGULAR MEETING
March 9, 2026, at 1:30 PM**

Wooton Hall, Room 105
2995 Knox Street
Las Cruces, NM 88003

Recording located at: <https://regents.nmsu.edu/regent-meetings/>

Regents of New Mexico State University

Chair Ammu Devasthali, Vice Chair Deborah Romero, Secretary/Treasurer Christopher T. Saucedo, Marisol Olivas, Ricardo Gonzales

Non-Voting Advisory Members - ASNMSU President Wyatt Ziehe, Faculty Senate Chair Vimal Chaitanya, Ph.D., Employee Council Chair Sonia A. White

University Officials - President Valerio Ferme, Ph.D., Interim Provost Lakshmi Reddi, Ph.D., Vice President for Administration and Finance Allen Bottorff, P.E., Ph.D., General Counsel Lisa Henderson, J.D.

MINUTES

A. Call to Order, Chairwoman Ammu Devasthali

Chairwoman Devasthali called the regular meeting to order at 1:32 PM.

Pledge of Allegiance

The Pledge of Allegiance was led by Mr. Pete DeLeon from the NMSU Army ROTC. Mr. DeLeon, a recipient of a four-year National Army Scholarship, shared that he is currently in his second year (MS2) at NMSU.

1. Welcome, Nick Webb, USDA-ARS Jornada Experimental Range

Dr. Nick Webb welcomed the Regents to Wooton Hall, the headquarters for the USDA Agricultural Research Service (ARS) Range Management Research Unit. He highlighted the long history of collaboration between the "Jornada" and NMSU, noting that their high-profile research projects in precision ranching and agrivoltaics contribute significantly to the university's R1 status.

2. Introduction of the Media and Elected Officials, Chief of Staff Justin Bannister

Chief of Staff Justin Bannister reported that no media or elected officials were in attendance.

3. Introductions

a) Introduction of the newly elected chair of NMSU Employee Council, Sonia A. White, President Valerio Ferme

President Ferme introduced Sonia A. White as the newly elected chair of the NMSU Employee Council. Ms. White, a three-time NMSU graduate and Instructional Technology Administrator, noted it was exactly six years to the day since she previously concluded a term as chair of the council.

4. Confirmation of Quorum, Chairwoman Ammu Devasthali

A roll call was taken, and a quorum was confirmed with Regents Gonzales, Olivas, Saucedo, Romero, and Devasthali all present. Regent Saucedo joined via Zoom.

5. Approval of the Agenda, Chairwoman Ammu Devasthali

A motion was made by Regent Gonzales and seconded by Regent Romero to approve the agenda. The motion passed.

B. Approval of Minutes

1. Special Meeting on February 18, 2026

A motion was made by Regent Olivas and seconded by Regent Gonzales to approve the minutes for the Special Meeting on February 18, 2026. The motion passed.

C. Regent Committee Reports

1. Audit and Risk Committee Report, Regent Ricardo Gonzales

Regent Ricardo Gonzales reported the committee met on February 26 to receive an internal audit update from John Fry.

a) 2024 2025 Financial Report for Fiscal Year Ended June 30, 2025, Lisa Todd (Baker Tilly)

Lisa Todd (Baker Tilly) presented the FY25 audit results. NMSU received an unmodified (clean) opinion for the financial statements and federal single audit. A material audit adjustment of \$1.6 million was noted for the Arrowhead component unit due to lease reporting errors, though this was not considered material at the university level.

2. Financial Strategies, Performance and Budget Committee Report, Regent Deborah Romero

Regent Deborah Romero reported the committee met on March 3 to approve capital projects and a course fee request.

3. Student Success Committee Report, Regent Christopher Saucedo

Regent Christopher Saucedo reported the committee met on February 25 to review two new academic program proposals and graduate enrollment trends.

D. Advisory Member Reports

1. Associated Students of NMSU Report, President Wyatt Ziehe

President Wyatt Ziehe reported that ASNMSU secured approximately \$2 million in legislative funding for campus safety and field improvements. He also noted that student fees will remain flat for the next cycle.

2. NMSU Faculty Senate Report, Chair Vimal Chaitanya

Chair Vimal Chaitanya highlighted the ongoing Provost search and the creation of a task force to improve the international student experience. He also announced Kristian Finlator as the chair-elect for the next semester.

3. NMSU Employee Council Report, Chair Sonia A. White

Chair Sonia A. White announced the new executive team and shared that Founders Day is scheduled for April 15.

E. Affiliated Entity Reports

1. NMSU Foundation Inc. Report, NMSU Foundation CEO Sylvia Y. Acosta

CEO Sylvia Acosta reported that the Foundation has raised \$18.5 million so far this year and is nearing a "large foundation" status with nearly \$500 million in total assets.

2. Arrowhead Center Inc. Report, Interim Director & CEO Winnie (Yu-Feng) Lee

Interim Director Winnie Lee announced an additional \$8 million in state appropriation for the soundstage project.

3. Aggie Development Inc. Report, CEO Scott Eschenbrenner

CEO Scott Eschenbrenner provided updates on new construction for White Sands Federal Credit Union and Blake's Lotaburger and reported interest from a developer for a senior retirement community at Aggie Uptown.

F. Public Comment, Associate Vice President Abby Butler

Associate Vice President Butler noted that nobody had signed up for public comment.

G. Consent Items, Chairwoman Ammu Devasthali

The consent agenda was approved, with Regent Gonzales abstaining from Item G4.

1. 2026 Annual Open Meetings Notice Resolution, University General Counsel Lisa Henderson

2. Confirmation of DACC Spring 2026 Honorary Degree Recipient Selection, NMSU Community Colleges Chancellor Mónica Torres

3. City of Las Cruces Right of Way Easement - Natural Gas Pipeline, Special Assistant to the President Scott Eschenbrenner

4. El Paso Electric Easement – Office of Emergency Management Building, Special Assistant to the President Scott Eschenbrenner

5. DACC Electric Boilers Conversion, Interim Associate Vice President Scott Eschenbrenner

6. Piñon Hall Roof Repair, Interim Associate Vice President Scott Eschenbrenner

7. Disposition and Deletion of Capital Property, University Controller Ross Justus

8. Philanthropic naming of Motion Capture Lab located in Milton Hall, Room #189, the "Kevin Andrew Long Motion Capture Lab", NMSU Foundation CEO Sylvia Y. Acosta

9. Philanthropic naming of Conference Room 253A in the Pan American Center, the "Shari Jones Conference Room", NMSU Foundation CEO Sylvia Y. Acosta

H. **Action Items, Chairwoman Ammu Devasthali**

Due to scheduling constraints, Chairwoman Devasthali changed the presentation order of the action items to begin with the Anthropology Course Fee request.

1. **Anthropology Course Fee Request, Academic Department Head Lois Stanford,**

Assistant Professor Katie Richards

Professor Katie Richards presented a proposal to raise the fee cap for the Archaeology Field School from \$1,500 to \$2,000 to account for inflation since 2016. A motion for approval was made by Regent Romero and seconded by Regent Olivas. Motion passed.

2. **Computational Social Science - Doctor of Philosophy, Rick Marlatt, David Ortiz Canseco**

David Ortiz Canseco presented this new interdisciplinary degree blending social sciences with machine learning and AI. A motion for approval was made by Regent Saucedo and seconded by Regent Gonzales. Motion passed.

3. **Artificial Intelligence Technician - Associate of Applied Science, Shannon Bradley, Jon Juarez**

Shannon Bradley and Jon Juarez presented this 60-credit workforce-ready degree. A motion for approval was made by Regent Saucedo and seconded by Regent Gonzales. Motion passed.

4. **Election of Officers, Chairwoman Ammu Devasthali**

The following officers were elected by acclamation for the coming year:

- Chair: Ammu Devasthali
- Vice Chair: Deborah Romero
- Secretary-Treasurer: Christopher T. Saucedo

I. **Informational Items, Chairwoman Ammu Devasthali**

1. **Summary of Revisions to the Administrative Rules and Procedures of NMSU (ARP) for the period December 1, 2025 - February 28, 2026, University Policy Officer Donna Ottaviano**

Donna Ottaviano provided a summary of policy revisions from Dec. 2025 through Feb. 2026.

J. **NMSU System Report, President Valerio Ferme**

President Ferme reported that spring 2026 census numbers were 831 students higher than the previous year. He also announced that Supreme Court Justice Briana Zamora would visit campus on March 24.

K. **NMSU Academic Report, Interim Provost Lakshmi Reddi**

Interim Provost Lakshmi Reddi presented data on state workforce needs and alumni retention, noting that approximately one-third of NMSU graduates remain in New Mexico.

L. **Report from the New Mexico Department of Agriculture to the Regents of New Mexico State University (Board of Agriculture), Secretary Jeff Witte**

Secretary Jeff Witte discussed Senate Bill 143, which updated fee caps for the department, and highlighted international trade successes for the pecan and dairy industries.

M. **Announcements and Comments, Chairwoman Ammu Devasthali**

1. **Good News for NMSU!**

- Regent Olivas and former Regent Garrett Mosley were selected for the 2026 Western Governors Leadership Institute.
- Regent Olivas was accepted to present research in Ireland this summer.
- Regent Gonzales highlighted national recognition for student workers at the NMSU radio station (KRUX 91.5).

N. **Adjournment, Chairwoman Ammu Devasthali**

A motion was made by Regent Olivas to adjourn at 3:40 PM. Motion passed.

DRAFT



**Board of Regents Meeting
Meeting Date: April 1, 2026
Agenda Item Cover Page**

Agenda Item: F-1

- Action Item
- Consent Item
- Informational Item

Presented By:

Scott Eschenbrenner
Interim Associate Vice President,
Facilities & Services

Agenda Item:

Atkinson Music Building Roof C Replacement

Requested Action of the Board of Regents:

Approval of the Atkinson Music Building Roof C Replacement

Executive Summary:

Design and construct a new roof to replace the existing roof C at the Atkinson Music Building.

References:

N/A

Prior Approvals:

N/A

ATKINSON MUSIC BUILDING ROOF C REPLACEMENT

Presented to the Board of Regents
April 1, 2026

FACILITIES AND SERVICES

Berta Zubiante
575.646.2199
bzubiante@nmsu.edu

Scott Eschenbrenner
575.646.2356
sbrenner@nmsu.edu

Jose Loera
575.646.5013
jloera@nmsu.edu

NM
STATE

BE BOLD. Shape the Future.®
New Mexico State University

Facility Information

| Property Profile | Type |
|------------------|----------------------------------|
| Year Built | 1911 (Military Science Building) |
| Last Expansion | Expansion 1983 (Music Building) |
| Project Size | Area C: 17,430 sq. ft. |



Atkinson Hall Music Building

Project Rationale

The existing roof system has exceeded its useful life. Roof leaks require constant patching and recurring maintenance.

Existing Conditions



Roof Patching



Parapet worn down with holes
allowing water intrusion



Dirt staining, cracking and bubbling
of the roof

Music Building Roof Area C

Facility Condition Index

Music Building
FCI: 0.33



\$6,626,505
 Total Identified Need

Campus
All

Portfolio
All

Building
MUSIC BUILDING

Need by Level 1

Timeframe: ● Backlog ● A ● B ● C

For all charts, use the dropdown arrows to drill down to further levels of detail.

Need by Levels 2 & 3

| | |
|--------------------------------|------------------------|
| D20 - Plumbing | C30 - Interior Fini... |
| D2023 - Domest... | D2033 - ... |
| D2010 - Plumbing Fixtures ... | C3023 - Floor Finishes |
| D30 - HVAC | D50 - Electri... |
| D3063 - Controls & Instrume... | D30... |
| D3053 - Terminal and Packag... | D30... |
| B20 - Exterior Enclosure | D40 - Fire Pr... |
| B2023 - Exterior Wind... | D4013 - Sprinklers |
| E10 - Equipment | B30 - Roofing |
| E1093 - Other Equipment | B3013 - Roof Co... |

Campus Need by Level 1

Level2

- B10 - Supers...
- B20 - Exterio...
- B30 - Roofing
- C30 - Interior...
- D20 - Plumbi...
- D30 - HVAC
- D40 - Fire Pr...
- D50 - Electric...
- E10 - Equipm...

Database Need by Level 1

Level1

- (Blank)
- A - Substruct...
- B - Shell
- Building Site...
- C - Interiors
- D - Services
- E - Equipmen...
- Equipment a...
- F - Special Co...
- G - Building S...
- H - General C...

● Backlog ● A (1 - 3 Years) ● B (4 - 7 Years) ● C (8-10 Years)

Scope of Work

Project Budget is \$910,000

- Demolish the existing roof system to the roof deck
- Repair any subsurface damage to the roof deck and parapet walls
- Installation of a new roofing system to meet current energy and code compliance

Project Schedule

| Project Stages | Date |
|----------------------------|----------------|
| Start of Design | February 2026 |
| Completion of Design | March 2026 |
| Start of Construction | June 2026 |
| Completion of Construction | September 2026 |

Approvals

| Committee Name | Date |
|--|----------------|
| Regents Financial Strategies, Performance and Budget Committee | March 12, 2026 |
| Board of Regents | April 1, 2026 |
| Higher Education Department | May 13, 2026 |
| State Board of Finance | June 16, 2026 |

Funding Source \$910,000

| Year | Funding Type | Funding Source | Amount | Reversion Date |
|------|---|----------------|-----------|----------------|
| FY26 | Recurring BRR (Building Renewal & Replacement) | NMSU Funds | \$910,000 | June 30, 2029 |

Budget Breakdown

| Description | Funding Total | Percentages |
|---------------------------------|------------------|-------------|
| Building Cost | | |
| General (MACC) | \$720,000 | |
| Construction Contingency | \$83,425 | 9.2% |
| Professional Fees | | |
| Architect/Engineering | \$51,975 | 5.7% |
| Project Administration | \$54,600 | 6% |
| Total | \$910,000 | |



Board of Regents Meeting
Date: April 1, 2026
Agenda Item Cover Page

Agenda Item: F-2

- Action Item
- Consent Item
- Informational Item

Presented By:

Scott Eschenbrenner
Interim Associate Vice President,
Facilities & Services

Agenda Item:

Genesis A Renovations and Pilot Lab Expansion

Requested Action of the Board of Regents:

Approval of the Genesis A Renovations and Pilot Lab Expansion

Executive Summary:

This project will expand the pilot lab, construct a greenhouse, expand existing lab areas, and install casework.

References:

N/A

Prior Approvals:

N/A

GENESIS A RENOVATIONS AND PILOT LAB EXPANSION

Presented to the Board of Regents
April 1, 2026

FACILITIES AND SERVICES

Berta Zubiate
575.646.2199
bzubiate@nmsu.edu

Scott Eschenbrenner
575.646.2356
sbrenner@nmsu.edu

Jose Loera
575.646.5013
jloera@nmsu.edu



BE BOLD. Shape the Future.®
New Mexico State University

Facility Information

| Property Profile | Type |
|------------------|----------|
| Year Built | 1987 |
| Project Size | |
| Pilot Lab | 788 SF |
| Greenhouse | 910 SF |
| Renovated Area | 5,000 SF |

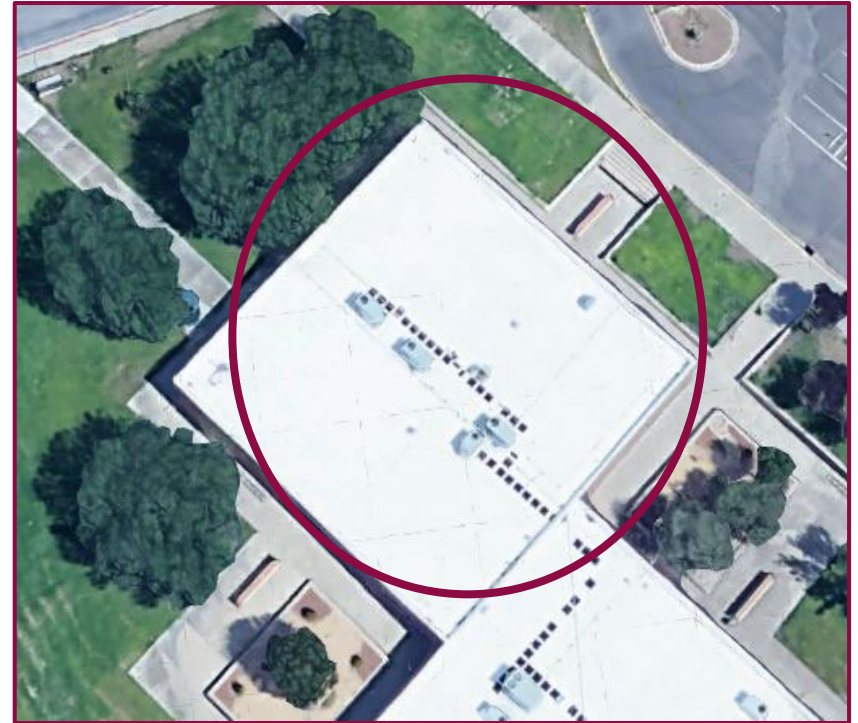

Genesis A Building

Existing Conditions



Interior of Existing Lab



Existing Lab from Exterior of Building

Genesis Center A

Project Rationale

The Genesis A Water Lab renovation is critical for New Mexico Produced Water Research Consortium (NMPWRC) and NMSU to develop a world-class research and testing center focused on alternative water supplies.

This front-line water research lab will enable the development of innovative water treatment technologies, improve analytical capabilities for comprehensive characterization of water quality, and ensure the safety of using the treated water agriculture irrigation.

The project supports New Mexico's Produced Water Act and Strategic Water Supply Program by strengthening the state's capacity to address water scarcity through science- and technology-driven solutions.

The upgraded lab will position New Mexico as a national leader in water security, responsible reuse, desalination, and treatment innovation while supporting science-based decision-making and regulatory planning.

Project Rationale (Continued)

The building expansion will support pilot-scale treatment systems that demonstrate technologies to improve the quality and safety of alternative water sources, and research focused on sustainable water reuse.

Key areas include produced water treatment, brackish water desalination and brine valorization, toxicity studies through a Biosafety Level II lab, greenhouse research on irrigation reuse, and environmental impact studies on contaminant fate and transport.

These initiatives will contribute to cutting-edge research and provide valuable educational opportunities for our students, preparing them to tackle future water challenges, and expand the critical water engineering pipeline.

Scope of Work

Project Budget is \$2,955,544

The construction cost estimate was provided by a third-party consultant hired by the architect.

- Consolidation of interior spaces in order to optimize lab workflow
- 788 SF building addition for pilot lab, which will house new water treatment equipment
- Placement of concrete foundation and assembly of an exterior 910 SF greenhouse
- 5000 SF of interior renovations to replace all finishes, providing new laboratory casework
- Renovation of existing lab areas to include a section dedicated for the Biosafety Level II lab
- Creation of multi-purpose spaces to include shared offices and student classroom/commons
- Renovations to existing restrooms to include new plumbing fixtures and layout

Project Schedule

| Project Stages | Date |
|------------------------------|---------------------------|
| Design Phase | August 2025 to April 2026 |
| Estimated Construction Phase | June 2026 to June 2027 |

Approvals

| Committee Name | Date |
|--|----------------|
| Regents Financial Strategies, Performance and Budget Committee | March 12, 2026 |
| Board of Regents | April 1, 2026 |
| Higher Education Department | May 13, 2026 |
| State Board of Finance (If Applicable) | June 16, 2026 |

Funding Source \$2,955,544

| Year | Funding Type | Funding Source | Amount | Reversion Date |
|------|-----------------------|----------------------|-----------|----------------|
| FY26 | General Fund Bond HB2 | State Appropriations | 4,015,000 | June 30, 2027 |

```

5      (309)NEW MEXICO STATE UNIVERSITY          4,015.0                                4,015.0
6      To purchase equipment, instrumentation, laboratory facility improvements and other supplies for water
7      treatment for expenditure in fiscal year 2026.
  
```

The \$1,059,456 difference between appropriation and project budget, is to be utilized by the College of Engineering to purchase specialized equipment outside of this project.

Budget Breakdown

| Description | Funding Total | Percentages |
|---------------------------------|--------------------|-------------|
| Building Cost | | |
| General | \$2,324,069 | |
| Construction Contingency | \$295,000 | 10% |
| Professional Fees | | |
| Architect/Engineering | \$210,865 | 7.15% |
| Project Administration | \$125,610 | 4.25% |
| Total | \$2,955,544 | |

Proposal for Renovation of Genesis A Water Desalination Laboratory

Submitted by the College of Engineering, New Mexico State University

New Mexico faces an unprecedented water crisis due to chronic droughts. This has incentivized municipalities and industries to evaluate the use of alternative waters, as ways to augment existing supplies, strengthen resiliency, and support existing and growing economies. The urgency to develop alternative water supplies has prompted new State and federal efforts, which have culminated in the instantiation of new funding opportunities and the passing of regulations and guidelines to support alternative water supply development. New Mexico State University has an exemplary track record in water reuse, desalination, and alternative water treatment for fit-for-purpose, including brackish water, produced water, and municipal wastewater. The funding will assist in establishing and modernizing a water desalination lab at NMSU to address water security issues and enhance research capacity for the state of New Mexico.

The requested funding of \$4,015,544 (see Table 1) will be used to upgrade lab build a front-line water research lab that will enable the development of innovative water treatment technologies, improve analytical capabilities for comprehensive characterization of water quality, and ensure the safety of using the treated water agriculture irrigation. The Genesis A Lab will support the following research and education activities at NMSU.

- Produced Water Treatment and Reuse

NMSU has collaborated with the New Mexico Environment Department and established the New Mexico Produced Water Research Consortium (NMPWRC) to **advance scientific and technological solutions related to the treatment and reuse of produced water**. NMPWRC is a trans-disciplinary public-private partnership comprised of academia, government agencies, national laboratories, and the private sector. **The renovated water research lab will play a critical role in conducting scientifically-based research to support and foster regional sustainability for the safe reuse of produced water.** The expansion of the building will provide the space for the installation and operation of the integrated pilot-scale treatment systems. These important efforts will help New Mexico lead the nation in saving fresh water for future generations.

- Brackish Water Desalination and Brine Valorization

Brackish water is considered a strategic water supply in New Mexico. **NMSU is a leading institution in brackish water treatment in the United States.** For example, NMSU is part of the National Alliance for Water Innovation (NAWI) team that was awarded the U.S. Department of Energy a ten-year, \$185 million grant to create the Energy-Water Desalination Hub to address water security issues. Currently, NMSU is leading seven research and pilot demonstration projects funded by NAWI on **brackish water desalination and brine valorization**. The support of the water desalination research facility at NMSU was identified as a high priority in 2023 by the New Mexico Legislature. Below is a quote from a Letter of Support from Senator George K Munoz, former Chair of the Legislative Finance Committee:

*“The benefits of supporting desalination projects at NMSU extend beyond addressing immediate water scarcity concerns. **These initiatives will contribute to cutting-edge research and provide valuable educational opportunities for our students, preparing them to tackle future water challenges, and expand the critical water engineering pipeline.** Furthermore, successful desalination projects can serve as models for other communities in New Mexico, fostering knowledge transfer and encouraging the adoption of sustainable water management practices statewide.”*

- **Toxicity Studies to Protect Public Health and Environment**

The renovation of the Genesis A Lab will include building a **Biosafety Lab Level II for toxicity studies**. Protecting public health and the ecological environment is crucial during water treatment and reuse. **This biosafety lab will allow for controlled experiments to identify, monitor, and quantify toxic compounds in alternative waters that might arise during various treatment processes, helping to ensure that treated water is free of harmful substances.** We plan to equip the biosafety labs to conduct cutting-edge bioassays using animals (e.g., mice), aquatic life (e.g., fish, water fleas, algae, and bacteria), and human cell lines. **The biosafety lab will provide a secure space to study these organisms and other toxic contaminants, helping NMSU researchers understand how to mitigate their impact in water treatment settings effectively.** The development of the biosafety lab will not only support our ongoing toxicity studies funded by the Bureau of Reclamation and NMPWRC but also will support us in pursuing larger research grants, such as through NIH.

- **Greenhouse Study for Reuse in Agricultural Irrigation**

The Genesis A Lab will be expanded for the **construction of a greenhouse to evaluate the risk of using treated produced water and brackish water for irrigation**. The greenhouse will provide controlled environments for studying the responses of crops to water after various levels of treatment. We will assess plant health by investigating seed germination, root growth, shoot growth, leaf area, relative water content, and biomass. We will also study the impact of desalinated water on the physical, chemical, and biological properties of the soil. The plants, soil, and soil leachate will also be analyzed to determine the residual organic and inorganic constituents in the desalinated water.

- **Clean Hydrogen Production and Renewable Energy Powered Water Treatment**

The pilot lab at Genesis A will be expanded and renovated to **host research and demonstration projects on clean hydrogen production and renewable energy-powered water treatment systems**. Currently the NMSU team has submitted two patent applications (one national and one international) on hydrogen production using water splitting and plastic waste photo-reforming. **The new building addition** and installation of additional ductwork and roof mounted exhaust fan will enhance the safety of conducting hydrogen research at NMSU. In addition, NMSU is collaborating with hydrogen industry on developing clean hydrogen in New Mexico, including Plug Power, Kit Carson, Electricity Power Research Institute.

The expansion and renovation of the pilot lab in Genesis A will allow the safety of handling instrumentation and protocols needed to conduct hydrogen research and analyses accurately and in compliance with safety standards.

- **Fate and Transport Studies for Assessing Environmental Impacts**

The new greenhouse and building addition at Genesis A will provide research capacity on the fate and transport of environmental contaminants from bench to field scales. The potential beneficial uses of treated alternative water resources (e.g., produced water and brackish groundwater) may have significant environmental impacts due to the occurrence of remaining hydrocarbons and inorganic substances. The NMSU team has made preliminary progress in investigating the retention and migration of produced water-related contaminants in the subsurface. The current research set up bench-scale soil columns to observe fate-and-transport behaviors and applied processes-based simulation to quantify potential uncertainty. With the facility expansion and further instrument investment, Genesis A will be able to upscale fate-and-transport studies by preparing larger soil columns and support research activities at a field scale.

- **Studying Contaminants of Emerging Concerns for Protecting Public Health**

The Genesis A lab will also focus on studying the contaminants of emerging concerns, especially per- and polyfluoroalkyl substances (PFAS), which is essential for addressing modern environmental and public health challenges. **A dedicated research lab for studying PFAS and other water contaminants can play a crucial role in advancing water safety and treatment technologies.** A specialized “clean” lab would prevent cross-contamination of water treatment processes because PFAS are persistent in the environment and can come from many sources. The knowledge generated in this specialized lab on contaminants like PFAS directly supports regulatory agencies, such as New Mexico Environment Department and USEPA, and DOD, in creating and updating standards for safe drinking water. Our research will also benefit many communities that are contaminated by PFAS in drinking water by developing cost-effective treatment technologies.

Summary of Impacts

The renovated research lab in Genesis A will create opportunities for collaboration among researchers at NMSU, water utilities and communities, industry, regulatory agencies, and policymakers. It could serve as a hub for training future scientists, engineers, and professionals in best practices for dealing with innovative water technologies, clean energy, emerging contaminants, and public health. This collaborative environment will accelerate the discovery and implementation of effective water treatment solutions and raise awareness about the importance of energy-water-public health nexus.

The lab will enhance the water research program and benefit the entire state by boosting water supplies, which are essential drivers of New Mexico's economy. More importantly, the program will benefit New Mexico by enhancing public and environmental health, improving water sustainability via creating drought-proof supplies to support resilience, reducing demand for

traditional freshwater, and promoting economic development by creating additional water and clean energy for new and growing industries that create jobs.

Requested Budget

The budget requested includes \$1,060,000 for instruments and equipment and \$2,955,544.38 for Genesis A Lab demolition and renovation, which includes existing lab renovation (\$1,012,651.39), 1000-square-foot greenhouse construction (\$715,802.6) to ensure the safety of agriculture irrigation using treated water, and 1200-square-foot building addition (\$1,227,090.31) for more pilot-scale treatment systems (please refer to the details in the attachment).

Table 1. Estimated budget for Developing Water Research Lab in Genesis A

| Item | Instruments and equipment | Costs |
|------------------|--|--------------------|
| 1 | Hach DR6000™ UV VIS Spectrophotometer, for water quality analysis | \$15,000 |
| 2 | Fourier Transform Infrared Spectrometer with ATR detector, for membrane and polymer analysis | \$60,000 |
| 3 | Horiba Aqualog - Environmental Water Research Analyzer for monitoring colored dissolved organic matter (CDOM) in produced water | \$60,000 |
| 4 | VETSCAN® HM5 Hematology Analyzer, for animal blood analysis | \$17,000 |
| 5 | High Speed Ultracentrifuge for new membrane materials synthesis | \$100,000 |
| 6 | Inverted Microscope with camera, for zebrafish and human cell toxicity | \$8,000 |
| 7 | Zebrafish culture system for aquatic toxicity assays | \$30,000 |
| 8 | Environmental chamber, for algal and water flea toxicity assays | \$20,000 |
| 9 | Labconco Protector Controlled Atmosphere Glove Boxes for membrane material synthesis | \$40,000 |
| 10 | QSense Omni, 2 channels, QCM-D for membrane fouling study | \$100,000 |
| 11 | Gas chromatography-flame ionization detection (GC-FID), for separating and analyzing volatile components | \$60,000 |
| 12 | Soil monitoring system with soil moisture/temperature/EC sensors and related datalogger for contaminant fate and transport study | \$30,000 |
| 13 | Soil Moisture Retention Curve System for soil moisture measurement | \$17,000 |
| 14 | Ultrapure Water Purification System to generate deionized water | \$23,000 |
| 15 | Autoclave for sterilization of containers/reagents for toxicity assays | \$20,000 |
| 16 | 2 electrodialysis stacks for desalination of produced water and brackish water | \$200,000 |
| 17 | TOC online analyzer-for real-time analysis of total organic carbon in water samples | \$100,000 |
| 18 | Fluorescence excitation emission matrix (FEEM) spectroscopy | \$100,000 |
| 19 | Thermal evaporator to recover valuable minerals in produced water | \$60,000 |
| Sub-total | | \$1,060,000 |

| | | |
|--------------|--|--------------------|
| 17 | Genesis A Lab demolition and renovations | \$2,955,544 |
| Total | | \$4,015,544 |

HB2 (2025 Legislative Session)

(309)NEW MEXICO STATE UNIVERSITY 4,015.0 4,015.0

To purchase equipment, instrumentation, laboratory facility improvements and other supplies for water treatment for expenditure in fiscal year 2026.

HB2 (2026 Legislative Session)

(247) NEW MEXICO STATE UNIVERSITY

The period of time for expending the four million fifteen thousand dollars (\$4,015,000) appropriated from the general fund in Subsection 309 of Section 5 of Chapter 160 of Laws 2025 to purchase equipment, instrumentation, laboratory facility improvements, and other supplies for water treatment is extended through fiscal year 2028.

In House Bill 2, “water treatment” refers to the acquisition of equipment, instrumentation, and facility improvements necessary to research, develop, test, and demonstrate technologies that improve the quality, safety, and usability of alternative water sources such as produced water, brackish groundwater, and wastewater.

In this project, “water treatment” refers to the development, testing, and pilot-scale demonstration of technologies that improve the quality and safety of alternative water sources such as produced water, brackish groundwater, and wastewater. The funding supports research equipment, laboratory upgrades, and pilot systems that allow NMSU to evaluate treatment performance, environmental impacts, and practical reuse applications relevant to New Mexico’s long-term water security.

Color Key

Reflected into Powerpoint presentation

Key Points highlighted by Dean David Jauregui

Legislative Language and Scope of Work Comparison.



**Board of Regents Meeting
Meeting Date: April 1, 2026
Agenda Item Cover Page**

Agenda Item: G-1

- Action Item
- Consent Item
- Informational Item

Presented By:

Mark Cal
ALCC Campus Executive & Academic
Officer

Agenda Item:

ALCC Books4Less \$4 Per Credit Hour Increase

Requested Action of the Board of Regents:

Approval of ALCC Books4Less \$4 Per Credit Hour Increase

Executive Summary:

ALCC is requesting approval for a \$4 per credit hour increase to support the Books4Less program. This proposed adjustment aligns with the increase implemented by DACC last year and will help maintain program operations, address rising material and distribution costs, and enhance student access to required course resources.

References:

N/A

Prior Approvals:

University System Budget Committee on 03/10/2026

Books4Less NMSU Alamogordo Access Program



BE BOLD. Shape the Future.®
New Mexico State University



Books4Less

ALL COURSE MATERIALS.
ALL PUBLISHERS. TOTALLY SECURE.

Total Access

Campus Wide Affordable Access

- Books4Less ensures students receive required course materials before classes begin, typically one week prior to the start of the term.
- Digital materials are delivered directly through Canvas (NMSU's Learning Management System), allowing immediate access on computers and mobile devices.
- Physical materials are available for pickup NMSU Main Campus Bookstore or NMSU Alamogordo Student Support Services prior to the start of classes.
- Students pay a per-credit-hour course materials fee at registration, similar to tuition, ensuring predictable access for every student.
- Research shows students experience an average 15.5% increase in course completion rates when materials are available at the start of the term.
- NMSU Alamogordo implemented Books4Less in Fall 2023 to improve course success, reduce course drops and withdrawals, increase retention and graduation, increase affordability, and promote equity by leveling the playing field from a financial and socio-economic standpoint.



BE BOLD. Shape the Future.®

Key Books4Less Benefits

- **Faculty retain full academic freedom** to select the course materials that best support their curriculum and instruction.
- **Students have the option to opt out** of the program each term if they prefer to purchase their materials independently, ensuring flexibility while maximizing affordability and day one access.
- **Does not increase the cost of course materials** but shifts payment from out-of-pocket purchases after classes begin to a per-credit-hour charge at the time of registration. This ensures students are not negatively impacted by financial aid delays or forced to forego materials due to cost.
- **Provides predictability** to total education costs per semesters, allow students to better plan financially.



Books4Less Impact

OF STUDENTS SERVED

3,796 unique students served since Fall 2023

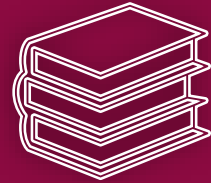

369

Unique Titles



\$2.0M

In Savings

97.9%

Student Participation

MATERIALS PROVISIONED



1,262 Physical Units



18,469 Digital Units

SAVINGS PER STUDENT PER SEMSTER

\$309.99



99.4%

Available on Class Start



BE BOLD. Shape the Future.®

Books4Less

What NMSU Students Are Saying

“

“I love how my books are there and ready to access.”

NMSU-A Student



“

“This was my first year of college and it made everything so easy and not stressful.”

NMSU-A Student



“

“It is a great program, especially the material being discounted prices. That really helps a lot financially.”

NMSU-A Student



“

“I had required materials on day one without delays.”

NMSU-A Student



BE BOLD. Shape the Future.®

Books4Less

What NMSU Students Are Saying

Grade Improvement

73% of NMSU-A students said being a part of Books4Less helped improve their overall grades.

100%

I was able to **easily access** my digital course materials.

4 of 5

NMSU-A students said Books4Less helped them feel **more prepared** for their classes

100%

Books4Less made the process of getting my materials **less stressful** and **more convenient**.

1/3

Books4Less **influenced my decision to attend** NMSU Alamogordo.



What is impacting Price?

Publisher Impact:

- Annual Publisher Increases
- Books4Less pricing remains negotiated below standard retail pricing
 - 2023-2024: 4-5%
 - 2024-2025: 4-5%
 - 2025-2026: 6-8%

Adopted Materials Impact:

- 21% increase in Courseware Units
- 56% Increase in Print Units
- Additional materials adopted

How Do We (NMSU-A) Mitigate Impact:

- Validate required vs. recommended materials
- Increase Low-cost or no-cost Open Education Resources (OER)
- Ensure Courseware is Required

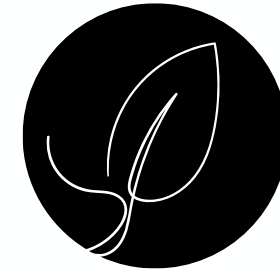

Proposed Price



CURRENT PRICE

- \$24 Per Credit Hour
 - Price remained constant for 9 consecutive terms (Fall 2023 – Summer 2026)



STARTING FALL 2026

- \$28 Per Credit Hour
 - Based on Spring 2025 – Fall 2025 expenditures
 - DACC's currenting pricing is \$28/credit hour

Represents 16.7% increase (approx. 5.6% per year)

Current Average New Retail Price: \$71.37/credit hour



BE BOLD. Shape the Future.®

What happens if this is not approved?

- Students would no longer benefit from aggregated, discounted pricing and would instead need to research and purchase course materials individually, often paying standard retail prices.
- The per-credit-hour pricing model and automatic delivery of course materials would no longer be available, and students would lose the convenience and reduction in stress they reported in survey results.

**Thank you for your
time.**

Questions?

Dr. Mark Cal

Chief Executive & Academic Officer

NMSU Alamogordo

575.439.3621

mcal@nmsu.edu

Collin King

Market Leader

575.496.1450

c.king@follett.com

EMILY PORTER

Director, Total Access

224.454.4633

eporter@follett.com



BE BOLD. Shape the Future.®



Board of Regents Meeting
Meeting Date: April 1, 2026
Agenda Item Cover Page

Agenda Item #G-2

- Action Item
- Consent Item
- Informational Item

Presented By: Jacob Nevarez
Assistant Vice President, Auxiliary Services

Agenda Item:

Dining Rates Increase of 3.7% to Premium and Voluntary Student Meal Plans

Requested Action of the Board of Regents:

Approval of Dining Rates Increase of 3.7% to Premium and Voluntary Student Meal Plans

Executive Summary:

We are requesting approval for a 3.7% increase to dining rates for the upcoming academic year. This adjustment applies exclusively to the Premium and Voluntary student meal plans. The Hometown Aggie meal plan will not be increased and will remain at its current rate. This proposed adjustment is necessary to address rising food, labor, and operational costs while maintaining the quality, variety, and availability of campus dining services. The increase aligns with the existing Sodexo contract, which allows for CPI-based adjustments, and ensures continued compliance with contractual obligations. Implementing this rate adjustment supports the long-term financial stability of dining operations and sustains current meal plan offerings for students.

References:

N/A

Prior Approvals:

University system Budget Committee on 03/10/2026

FY27 Proposed Meal Plan Rates

March 12, 2026

March 27, 2026 (updated – yellow highlight)



BE BOLD. Shape the Future.[®]
New Mexico State University

Meal Plan Rates Request Summary

- Meal Plans – Average 3.7% (Contractual, **based on CPI**)
 - Meal Plan rate increases are contractually based on Bureau of Labor Statistics, CPI, West Region, Food Away From Home and the Employment Cost Index, ECI.
 - FY27 rate increase request will average to the CPI & ECI inflationary factors, 3.7% as of November 2025.
 - CPI is not applied to Dining Dollars resulting in an effective, **blended FY27 rate increase of 2.7%**
for mandatory meal plans.
- There was no Meal Plan price increase from FY 2025 to FY 2026



5-year Meal Plan Price History

| Meal Plan | # of Meals per Week (16 weeks in total) | FY22 | FY23 | FY24 | FY25 | FY26 | FY27 (Proposed) |
|--|--|----------|------------------------------|------------------------------|------------------------------|----------|------------------------------|
| Required Meal Plans for On-Campus Freshmen | | | | | | | |
| Platinum Premium <i>Includes 3 premium "+plus Packages"</i> | 21 per week (366 total) | \$ 2,450 | \$ 2604 6.29% increase | \$ 2760 5.99% increase | \$ 2888 4.64% increase | \$ 2,888 | \$ 2982 3.25% increase |
| Classic Crimson <i>Includes 1 Basic "+Plus Package"</i> | 17 per week (272 total) | \$ 2,150 | \$ 2285 6.28% increase | \$ 2485 8.75% increase | \$ 2600 4.63% increase | \$ 2,600 | \$ 2689 3.42% increase |
| Hometown Aggies | 10 per week (160 total) | \$ 1,650 | \$ 1754 5.76% increase | \$ 1910 9.46% increase | \$ 1998 4.61% increase | \$ 1,998 | \$ 1,998 |
| Voluntary Meal Plans | | | | | | | |
| Block 150 | 150 | \$ 1,400 | \$ 1488 6.29% increase | \$ 1620 8.87% increase | \$ 1706 5.31% increase | \$ 1,706 | \$ 1769 3.69% increase |
| Block 75 | 75 | \$ 725 | \$ 771 6.34% increase | \$ 840 8.95% increase | \$ 885 5.36% increase | \$ 885 | \$ 918 3.73% increase |
| Block 35 | 35 | \$ 350 | \$ 372 6.29% increase | \$ 405 8.87% increase | \$ 426 5.19% increase | \$ 426 | \$ 442 3.76% increase |



Proposed FY27 Meal Plan Rates

| Meal Plan ⁽¹⁾ | # of Meals per Week (16 wks in total) | Aggie Dining Dollars | FY26 Rate | FY27 Rate (Proposed) | FY26 Rate Less Aggie Dining Dollars | FY27 Rate (Proposed) Less Aggie Dining Dollars | % Increase Adjusted for Dining Dollars ⁽²⁾ | \$ Increase Per Semester | Cost per Meal | Cost per Day (based on 112 Days in Semester) |
|--|---------------------------------------|----------------------|-----------|----------------------|-------------------------------------|--|---|--------------------------|---------------|--|
| Required Meal Plans for On-Campus Freshmen | | | | | | | | | | |
| Platinum Premium <i>Includes 3 Premium "+Plus Packages"</i> | 21 per week (336 total) | \$350 | \$2,888 | \$2,982 | \$2,538 | \$2,632 | 3.7% | \$94 | \$7.83 | \$23.50 |
| Classic Crimson <i>Includes 1 Basic "+Plus Package"</i> | 17 per week (272 total) | \$200 | \$2,600 | \$2,689 | \$2,400 | \$2,489 | 3.7% | \$89 | \$9.15 | \$22.22 |
| Hometown Aggies | 10 per week (160 total) | \$100 | \$1,998 | \$1,998 | \$1,898 | \$1,898 | 0.0% | \$0 | \$11.86 | \$16.95 |
| Voluntary Meal Plans | | | | | | | | | | |
| Block 150 | 150 | \$0 | \$1,706 | \$1,769 | | | 3.7% | \$63 | \$11.79 | |
| Block 75 | 75 | \$0 | \$885 | \$918 | | | 3.7% | \$33 | \$12.24 | |
| Block 35 | 35 | \$0 | \$426 | \$442 | | | 3.7% | \$16 | \$12.62 | |

(1) All figures are calculated using semester rates

(2) FY27 rate increase was calculated by adjusting the rate for Aggie Dining Dollars. Example: Total cost of Platinum Premium was \$2,888 in FY26. To calculate FY27 rate, we reduced the cost of the plan by the value of dining dollars (\$2,888 - \$350 = \$2,538) and increasing by the contractual rate of 3.7% (\$2,538 * 1.037 = \$2,631.91) and rounding to the nearest dollar.



BE BOLD. Shape the Future.®

Peer Institution Rate Comparison

| Premium / Unlimited Plans ⁽¹⁾ | Plan Details | Est. # of Meals ^{(2) (3)} | Add-ons | Semester | Dining Dollars in Plan | Total Cost Less Dining Dollars | Cost Per Meal | Cost Per Day (based on 112 days) |
|--|------------------|------------------------------------|--|----------------|------------------------|--------------------------------|---------------|----------------------------------|
| University of Wyoming | Unlimited | 336 | | \$3,825 | \$150 | \$3,675 | \$10.94 | \$32.81 |
| University of Nevada-Reno | Unlimited | 336 | 4 Guest Meals/Semester 1 meal Trade per Day | \$3,600 | \$400 | \$3,200 | \$9.52 | \$28.57 |
| Kansas State University | Unlimited | 336 | 5 Guest Meals/Semester | \$2,755 | \$0 | \$2,755 | \$8.20 | \$24.60 |
| Western New Mexico University | 19 Meal/week | 304 | | \$2,662 | \$175 | \$2,487 | \$8.18 | \$22.21 |
| University of Idaho | Unlimited | 336 | 4 weekly Gold Meals | \$2,965 | \$225 | \$2,740 | \$8.15 | \$24.46 |
| New Mexico Highlands | 19 Meal/week | 306 | | \$2,744 | \$355 | \$2,389 | \$7.81 | \$21.33 |
| University of New Mexico - Cedar Plan | Unlimited | 336 | 150 Meal Exchanges | \$2,829 | \$250 | \$2,579 | \$7.68 | \$23.03 |
| New Mexico State University | Unlimited | 336 | 3 premium subscriptions (\$600 value) | \$2,888 | \$350 | \$2,538 | \$7.55 | \$22.66 |
| Utah State University | Unlimited | 336 | | \$2,600 | \$100 | \$2,500 | \$7.44 | \$22.32 |
| New Mexico Tech | Unlimited | 336 | | \$2,611 | \$150 | \$2,461 | \$7.32 | \$21.97 |
| Iowa State University | Unlimited | 336 | 5 Guest Meals/Semester 2 GET & GO per day | \$2,682 | \$250 | \$2,432 | \$7.24 | \$21.71 |
| Eastern New Mexico University | Unlimited | 336 | | \$2,362 | \$150 | \$2,212 | \$6.58 | \$19.75 |
| Average | | | | \$2,877 | \$213 | \$2,664 | \$8.05 | \$23.79 |

(1) UTEP and Oklahoma State University are not listed because they do not offer unlimited plans

(2) A semester is reflected as 16 weeks for the purpose of calculating the number of meals per semester.

(3) For institutions that do not specify a number of meals as a basis for their unlimited plans, assume 336 (approx. 21 meals/week for 16 weeks).

(4) Peer rates shown are 2025-26 rates.



BE BOLD. Shape the Future.®

NMSU Meal Plans

2025-26 Dining Meal Plans

First-Year housing students are required to choose from Premium, Classic or Hometown meal plan.



| Premium Platinum \$2,888 21 swipes per week BEST PRICE | Classic Crimson \$2,600 17 Swipes per week | Hometown Aggies <i>Doña Ana County Residents only</i> \$1,998 10 swipes per week |
|--|---|---|
| 336 Meal Swipes - Taos Restaurant | 272 Meal Swipes - Taos Restaurant | 160 Meal Swipes - Taos Restaurant |
| \$350 Dining Dollars | \$200 Dining Dollars | \$100 Dining Dollars |
| Unlimited Fountain Drinks & 80 Medium Premium Coffees or Premium Boba Teas at Zuhl Fuel.  | Choose one from the following: <ul style="list-style-type: none"> o Unlimited Fountain Drinks o 32 Kiwibot Deliveries + 4 Wash & Folds o 50% off Concessions | CRAVING VARIETY? WE'VE GOT 15+ PLACES TO EAT!  |
| 64 Kiwibot Food Deliveries | BUILD YOUR OWN TAOS RESTAURANT Dining Swipes Valid only at Taos Restaurant. Swipes do not carry over from semester to semester. The cost listed below is per semester. |  Petes Dollars Valid at all on-campus retail outlets, dining dollars carry forward from Fall to Spring. The cost listed below is per semester. |
| 8 Wash & Fold Laundry Services | Aggie 150 for \$1,706.00 Aggie 75 for \$885.00 Aggie 35 for \$426.00 | Pete's 450 for \$405.00 Pete's 300 for \$270.00 Pete's 150 for \$135.00 |
| 1 Free Concessions Meal during NMSU athletic events |  | |



BE BOLD. Shape the Future.®



**Board of Regents Meeting
Meeting Date: April 1, 2026
Agenda Item Cover Page**

Agenda Item: G-3

- Action Item
- Consent Item
- Informational Item

Presented By:

Kim Rumford
Chief Budget Officer

Agenda Item:

Tuition & Mandatory Fees All Campuses

Requested Action of the Board of Regents:

Approval of Tuition & Mandatory Fees for All Campuses

Executive Summary:

Approval is requested for Tuition and Mandatory Fees across all campuses for Academic Year AY26/AY27. The proposed schedule reflects a 0% increase, keeping tuition and mandatory fees flat for the academic year.

References:

N/A

Prior Approvals:

N/A

NMSU - Las Cruces

Proposed Increase of 0% for Resident and Non-Resident Tuition and Fee Increase of 0%

0% Increase for NMSU Online

Table Reflects 0% Tuition and 0% Fee Increase

| Undergraduate | | | | | |
|--|------------------------|-----------------|-----------------|--------------------|-------------------|
| Resident Students | | | | | |
| | | FY26 | FY27 | \$ Increase | % Increase |
| UG Part Time (Per CH) Rate (Up to 14 CR) | Tuition | 261.80 | 261.80 | - | 0.0% |
| | Required General Fee | 60.96 | 43.44 | (17.52) | |
| | Athletic Fee | | 11.99 | 11.99 | |
| | IT Fee | | 8.20 | 8.20 | |
| | Academic Service Fee | 20.00 | 17.33 | (2.67) | |
| | Tuition and Fee | 342.76 | 342.76 | (0.00) | 0.0% |
| Flat Rate (15 credits and above) | | | | | |
| | | FY26 | FY27 | \$ Increase | % Increase |
| | Tuition | 3,364.10 | 3,364.10 | - | 0.0% |
| | Required General Fee | 914.40 | 651.60 | (262.80) | |
| | Athletic Fee | | 179.85 | 179.85 | |
| | IT Fee | | 123.00 | 123.00 | |
| | Academic Service Fee | 300.00 | 259.95 | (40.05) | |
| | Tuition and Fee | 4,578.50 | 4,578.50 | (0.00) | 0.0% |
| 135 Mile Texas Hourly Rate (1-14) | | | | | |
| | | FY26 | FY27 | \$ Increase | % Increase |
| | Tuition | 287.98 | 287.98 | - | 0.0% |
| | Required General Fee | 60.96 | 43.44 | (17.52) | |
| | Athletic Fee | | 11.99 | 11.99 | |
| | IT Fee | | 8.20 | 8.20 | |
| | Academic Service Fee | 20.00 | 17.33 | (2.67) | |
| | Tuition and Fee | 368.94 | 368.94 | (0.00) | 0.0% |
| 135 Mile Texas Flat Rate (15 credits) | | | | | |
| | | FY26 | FY27 | \$ Increase | % Increase |
| | Tuition | 3,700.51 | 3,700.51 | - | 0.0% |
| | Required General Fee | 914.40 | 651.60 | (262.80) | |
| | Athletic Fee | | 179.85 | 179.85 | |
| | IT Fee | | 123.00 | 123.00 | |
| | Academic Service Fee | 300.00 | 259.95 | (40.05) | |
| | Tuition and Fee | 4,914.91 | 4,914.91 | (0.00) | 0.0% |
| Non-Resident | | | | | |
| | | FY26 | FY27 | \$ Increase | % Increase |
| Rate per Credit (1-6 Credits) | Tuition | 327.25 | 327.25 | - | 0.0% |
| | Required General Fee | 60.96 | 43.44 | (17.52) | |
| | Athletic Fee | | 11.99 | 11.99 | |
| | IT Fee | | 8.20 | 8.20 | |
| | Academic Service Fee | 20.00 | 17.33 | (2.67) | |
| | Tuition and Fee | 408.21 | 408.21 | (0.00) | 0.0% |

| Rate per Credit (1-14 Credits) when enrolled in >6 credits | | FY26 | FY27 | \$ Increase | % Increase |
|--|------------------------|------------------|------------------|---------------|-------------|
| | Tuition | 975.30 | 975.30 | - | 0.0% |
| | Required General Fee | 60.96 | 43.44 | (17.52) | |
| | Athletic Fee | | 11.99 | 11.99 | |
| | IT Fee | | 8.20 | 8.20 | |
| | Academic Service Fee | 20.00 | 17.33 | (2.67) | |
| | Tuition and Fee | 1,056.26 | 1,056.26 | (0.00) | 0.0% |
| Flat Rate (15 credits and above) | | | | | |
| Flat Rate (15 credits and above) | | FY26 | FY27 | \$ Increase | % Increase |
| | Tuition | 12,527.30 | 12,527.30 | - | 0.0% |
| | Required General Fee | 914.40 | 651.60 | (262.80) | |
| | Athletic Fee | | 179.85 | 179.85 | |
| | IT Fee | | 123.00 | 123.00 | |
| | Academic Service Fee | 300.00 | 259.95 | (40.05) | |
| | Tuition and Fee | 13,741.70 | 13,741.70 | (0.00) | 0.0% |

| Graduate | | | | | |
|--|------------------------|-----------------|-----------------|---------------|-------------|
| Resident Students | | | | | |
| Resident Students | | FY26 | FY27 | \$ Increase | % Increase |
| Part Time (Per CH) Rate (Up to 14 CR) | | | | | |
| | Tuition | 287.80 | 287.80 | - | 0.0% |
| | Required General Fee | 60.96 | 43.44 | (17.52) | |
| | Athletic Fee | | 11.99 | 11.99 | |
| | IT Fee | | 8.20 | 8.20 | |
| | Academic Service Fee | 20.00 | 17.33 | (2.67) | |
| | Tuition and Fee | 368.76 | 368.76 | (0.00) | 0.0% |
| Flat Rate (15 credits and above) | | | | | |
| Flat Rate (15 credits and above) | | FY26 | FY27 | \$ Increase | % Increase |
| | Tuition | 3,697.90 | 3,697.90 | - | 0.0% |
| | Required General Fee | 914.40 | 651.60 | (262.80) | |
| | Athletic Fee | | 179.85 | 179.85 | |
| | IT Fee | | 123.00 | 123.00 | |
| | Academic Service Fee | 300.00 | 259.95 | (40.05) | |
| | Tuition and Fee | 4,912.30 | 4,912.30 | (0.00) | 0.0% |
| 135 Mile Texas Hourly Rate (1-14) | | | | | |
| 135 Mile Texas Hourly Rate (1-14) | | FY26 | FY27 | \$ Increase | % Increase |
| | Tuition | 316.58 | 316.58 | - | 0.0% |
| | Required General Fee | 60.96 | 43.44 | (17.52) | |
| | Athletic Fee | | 11.99 | 11.99 | |
| | IT Fee | | 8.20 | 8.20 | |
| | Academic Service Fee | 20.00 | 17.33 | (2.67) | |
| | Tuition and Fee | 397.54 | 397.54 | (0.00) | 0.0% |
| 135 Mile Texas Flat Rate (15 credits) | | | | | |
| 135 Mile Texas Flat Rate (15 credits) | | FY26 | FY27 | \$ Increase | % Increase |
| | Tuition | 4,067.69 | 4,067.69 | - | 0.0% |
| | Required General Fee | 914.40 | 651.60 | (262.80) | |
| | Athletic Fee | | 179.85 | 179.85 | |
| | IT Fee | | 123.00 | 123.00 | |
| | Academic Service Fee | 300.00 | 259.95 | (40.05) | |
| | Tuition and Fee | 5,282.09 | 5,282.09 | (0.00) | 0.0% |

| Non-Resident | | | | | |
|--|------------------------|------------------|------------------|--------------------|-------------------|
| Rate per Credit (1-6 Credits) | | FY26 | FY27 | \$ Increase | % Increase |
| | Tuition | 359.75 | 359.75 | - | 0.0% |
| | Required General Fee | 60.96 | 43.44 | (17.52) | |
| | Athletic Fee | | 11.99 | 11.99 | |
| | IT Fee | | 8.20 | 8.20 | |
| | Academic Service Fee | 20.00 | 17.33 | (2.67) | |
| | Tuition and Fee | 440.71 | 440.71 | (0.00) | 0.0% |
| Rate per Credit (1-14 Credits) when enrolled in >6 credits | | FY26 | FY27 | \$ Increase | % Increase |
| | Tuition | 1,001.30 | 1,001.30 | - | 0.0% |
| | Required General Fee | 60.96 | 43.44 | (17.52) | |
| | Athletic Fee | | 11.99 | 11.99 | |
| | IT Fee | | 8.20 | 8.20 | |
| | Academic Service Fee | 20.00 | 17.33 | (2.67) | |
| | Tuition and Fee | 1,082.26 | 1,082.26 | (0.00) | 0.0% |
| Flat Rate (15 credits and above) | | FY26 | FY27 | \$ Increase | % Increase |
| | Tuition | 12,859.50 | 12,859.50 | - | 0.0% |
| | Required General Fee | 914.40 | 651.60 | (262.80) | |
| | Athletic Fee | | 179.85 | 179.85 | |
| | IT Fee | | 123.00 | 123.00 | |
| | Academic Service Fee | 300.00 | 259.95 | (40.05) | |
| | Tuition and Fee | 14,073.90 | 14,073.90 | (0.00) | 0.0% |

| NMSU Online with 0% Tuition Increase | | | | | |
|---|---------|---------------|---------------|--------------------|-------------------|
| | | FY26 | FY27 | \$ Increase | % Increase |
| Undergraduate Rate per Credit Hour | Tuition | 395.40 | 395.40 | - | 0.0% |
| Graduate Rate per Credit Hour | Tuition | 444.40 | 444.40 | - | 0.0% |
| Military | Tuition | 250.00 | 250.00 | - | 0.0% |

New Mexico State University - Las Cruces
Required Fees - FY26 Fee Allocations & FY27 Requests
Recommend 0% increase in the required fee rate

| | Budgeted Fee Allocation FY2025-2026 | Restructured FY2026-2027 before Adjustments | Adjustments | Budgeted Fee Allocation FY2026-2027 | % Incr (Decr) from FY26 Allocation |
|------------------------------------|-------------------------------------|---|-------------|-------------------------------------|------------------------------------|
| Equipment Fee | \$ 600,000 | \$ 306,000 | - | \$ 306,000 | 0.0% |
| Corbett Center | 1,021,545 | 1,021,545 | 916 | 1,022,461 | 0.1% |
| Golf Course | 224,832 | 224,832 | 996 | 225,828 | 0.4% |
| Special Events | 1,117,628 | 1,117,628 | - | 1,117,628 | 0.0% |
| Aquatic Center | 418,834 | 418,834 | 1,941 | 420,775 | 0.5% |
| Activity Center Operations | 755,180 | 755,180 | 8,460 | 763,640 | 1.1% |
| Intramurals | 90,755 | 90,755 | 844 | 91,599 | 0.9% |
| Health Services | 2,948,333 | 2,948,333 | 40,217 | 2,988,550 | 1.4% |
| Health Services - OHP | 79,280 | 79,280 | 12,842 | 92,122 | 16.2% |
| Tennis Center | 103,895 | 103,895 | 5,500 | 109,395 | 5.3% |
| Athletics | 3,787,792 | | - | - | 0.0% |
| Construction Bonds : Debt Service | 3,600,000 | 3,600,000 | - | 3,600,000 | 0.0% |
| ASNMSU Student Activity | 736,923 | 736,923 | - | 736,923 | 0.0% |
| ASNMSU Endowment | 25,000 | 25,000 | - | 25,000 | 0.0% |
| ASNMSU Cardinal (Bldg Maint) | 20,000 | 20,000 | - | 20,000 | 0.0% |
| Campus Tutoring Service | 90,281 | 90,281 | (90,281) | - | -100.0% |
| Pride Band | 95,146 | 95,146 | - | 95,146 | 0.0% |
| Education Abroad | 40,700 | 40,700 | 4,795 | 45,495 | 11.8% |
| NMSU Cheerleaders | 100,000 | 100,000 | - | 100,000 | 0.0% |
| Transit | 318,986 | 318,986 | 216 | 319,202 | 0.1% |
| ICT | 1,455,274 | | - | - | 0.0% |
| Student Media | 147,724 | 147,724 | - | 147,724 | 0.0% |
| Library | 354,801 | 354,801 | - | 354,801 | 0.0% |
| Student Involvement and Leadership | 104,678 | 104,678 | - | 104,678 | 0.0% |
| Fraternity & Sorority Life | 22,000 | 22,000 | - | 22,000 | 0.0% |
| Leadership and Engagement | 1,560 | 1,560 | 440 | 2,000 | 28.2% |
| Student Life | 852,257 | 852,257 | 20,679 | 872,936 | 2.4% |
| Equity Inclusion and Diversity | 40,000 | 40,000 | - | 40,000 | 0.0% |
| Military Veterans Program | 8,000 | 8,000 | (8,000) | - | -100.0% |
| Family Resource Center | 55,000 | 55,000 | | 55,000 | 0.0% |
| Fire | 38,792 | 38,792 | 435 | 39,227 | 1.1% |
| Total Required Fees | \$ 19,255,196 | \$ 13,718,130 | \$ - | \$ 13,718,130 | 0.0% |

| | | | | |
|----------------------|-----------------|-----------------|-----------------|--------------|
| Rate per Credit hour | \$ 60.96 | \$ 43.44 | \$ 43.44 | 0.00% |
|----------------------|-----------------|-----------------|-----------------|--------------|

Notes for Recurring Adjustments:

| | Revised |
|---|-------------|
| Compensation 1% | \$ 53,429 |
| Fringe Rate Increase 1% | \$ 33,682 |
| Tennis Center for student compensation increase | \$ 5,500 |
| Education Abroad for scholarships | \$ 4,795 |
| Leadership and Engagement to support operations | \$ 440 |
| Fire Department for student compensation increase | \$ 435 |
| Military Veterans declined funding | \$ (8,000) |
| Tutoring replaced with alternative funding | \$ (90,281) |
| Total Adjustments | \$ - |

NMSU - Branch Campuses

Proposed Increase of 0% for Resident and Non-Resident Tuition with Fees Increase

| NMSU Alamogordo Tuition & Fee Rates - Current and Proposed | | | | | | | | | | |
|---|--|------|-------|--------------------------|--|------|-------|--------------------------|-----------------------------|-------------------|
| | 2025-2026 Actual Tuition and Fees | | | | 2026-2027 Actual Tuition and Fees | | | | | |
| | Tuition | Fees | Total | Full-Time Tuition & Fees | Tuition | Fees | Total | Full-Time Tuition & Fees | Full-Time Proposed Increase | Percentage Change |
| Resident In-District | 81 | 8 | 89 | 1,068 | 81 | 8 | 89 | 1,068 | - | 0% |
| Resident Out-District | 97 | 8 | 105 | 1,260 | 97 | 8 | 105 | 1,260 | - | 0% |
| Non-Resident | 225 | 8 | 233 | 2,796 | 225 | 8 | 233 | 2,796 | - | 0% |

Operational Mil Levy = 1 mil

| NMSU Dona Ana Tuition & Fee Rates - Current and Proposed | | | | | | | | | | |
|---|--|------|--------|--------------------------|--|------|--------|--------------------------|-----------------------------|-------------------|
| | 2025-2026 Actual Tuition and Fees | | | | 2026-2027 Actual Tuition and Fees | | | | | |
| | Tuition | Fees | Total | Full-Time Tuition & Fees | Tuition | Fees | Total | Full-Time Tuition & Fees | Full-Time Proposed Increase | Percentage Change |
| Resident In-District | 68.50 | 8.25 | 76.75 | 921.00 | 68.50 | 8.25 | 76.75 | 921.00 | - | 0% |
| Resident Out-District | 85.00 | 8.25 | 93.25 | 1,119.00 | 85.00 | 8.25 | 93.25 | 1,119.00 | - | 0% |
| Non-Resident | 236.75 | 8.25 | 245.00 | 2,940.00 | 236.75 | 8.25 | 245.00 | 2,940.00 | - | 0% |

Operational Mil Levy = 1.25 mils

| NMSU Grants Tuition & Fee Rates - Current and Proposed | | | | | | | | | | |
|---|--|------|-------|--------------------------|--|------|-------|--------------------------|-----------------------------|-------------------|
| | 2025-2026 Actual Tuition and Fees | | | | 2026-2027 Actual Tuition and Fees | | | | | |
| | Tuition | Fees | Total | Full-Time Tuition & Fees | Tuition | Fees | Total | Full-Time Tuition & Fees | Full-Time Proposed Increase | Percentage Change |
| Resident In-District | 81 | 8 | 89 | 1,068 | 81 | 8 | 89 | 1,068 | - | 0% |
| Resident Out-District | 91 | 8 | 99 | 1,188 | 91 | 8 | 99 | 1,188 | - | 0% |
| Non-Resident | 170 | 8 | 178 | 2,136 | 170 | 8 | 178 | 2,136 | - | 0% |

Operational Mil Levy = 1 mil